

A RAFT™ is an installation frame which is used under a cabinet, in place of a floor tile, in raised floor installations, to provide extensive benefits.

ADVANTAGES & BENEFITS

- The RAFT™ sits on the pedestal heads integrating into the raised floor installation
- RAFTs are bayed, just like cabinets
- Saves cost when compared to old fashioned installation methods
- Saves considerable installation time
- No tile cutting needed - saving further cost and mess
- Provides massive cable entry through base
- Base airflow is exceptional but may be sealed with Cannon brush gland
- Secures cab to pedestal system avoiding the need for tie bars to the floor substrate
- Lateral movement of raised floor installation becomes more rigid
- Allows minimised aisle widths and avoids cut tiles in aisle even for 1000mm deep cabinets as tiles in aisle slide under cabinet
- Tiles in aisle can be raised because of the resulting clearance from the raised cabinet base (cabinet sits 50mm above tile surface)
- RAFT™ accessories include brackets for commando connectors enabling power connections at RAFT™ level avoiding the need to enter floor void for power connection to PDUs etc



Saves pedestal costs, no tile cutting, quicker install, simplifies planning.

Avoids the need for intermediate pedestals. Only 600mm pitch pedestals are required, as no cut tiles means no intermediate pedestals

See Page 5.5 for details on RAFT™ Blanking options including Brush Strip

CABINET WIDTH	PART CODE	
CABINET FOOTPRINT	CENTRAL MOUNT	REAR OVERHANG
600 x 600	435B02606020	-
600 x 800	435B02608020	435B02608025
600 x 1000	435B02609920	435B02609925
600 x 1200	435B02601220	-
700 x 600	435B02706020	-
700 x 800	435B02708020	435B02708025
700 x 1000	435B02709920	435B02709925
700 x 1200	435B02701220	-
800 x 600	435B02806020	-
800 x 800	435B02808020	435B02808025
800 x 1000	435B02809920	435B02809925
800 x 1200	435B02801220	-



Centrally Mounted Cab shown on Cannon RAFT™ has been shown highlighted in red

RAFT is a registered trade mark of the Cannon Technologies Group Ltd

Size conversions: 1U = 44.45mm = 1 3/4" 600mm = 24" 700mm = 28" 800mm = 32" 1kg = 2.2lbs

T: +44(0)1425 632600 | CANNONTECH.CO.UK | SALES@CANNONTECH.CO.UK

The Cannon RAFT™ System is compatible with the majority of Raised Access Floors with a modular tile size of 600mm x 600mm in current use worldwide.

Installation of the Cannon RAFT™ System is very simple as the system is designed to replace complete floor tiles in Raised Access Flooring where Cannon cabinets are to be installed.

RAFT™ Depth

The RAFT™ consists of a series of individual ‘picture frames’ which are bolted together and which always have the same depth (front-to-back) dimension as a floor tile (600mm). Cabinets with a depth (front-to-back) dimension greater than 600mm, overhang the RAFT™ equally at front and rear, i.e. a 1000mm cabinet would overhang the RAFT™ by 200mm at the front and rear or may be offset/aligned with front of cabinet or rear.

However, the RAFT™ raises the cabinet above the floor sufficiently to allow the overhanging tiles to be raised vertically and slid sideways for access to the under floor void.

RAFT™ Width

It is preferable that the frame width matches the cabinet width (600, 700 or 800mm).

RAFT™ System Clamps

Single front & rear clamps (Order code: 307C11180500) - for use where stringers are not present. These clamps are slotted for adjustment and clamp to the underside of the pedestal heads. Four clamps per cabinet should be used, one in each corner, however, if the cabinets are securely bayed together it may be considered adequate to use two per cabinet (one front & rear). It is recommended that the end cabinets in a row, each have four clamps fitted, or at least the clamps should be to the ‘outside’ of these cabinets.

RAFT™ SYSTEM & Raised Floor Side View

The RAFT raises the cabinet above the floor sufficiently to allow the overhung tiles to be raised vertically and slid sideways for access to the under floor void.

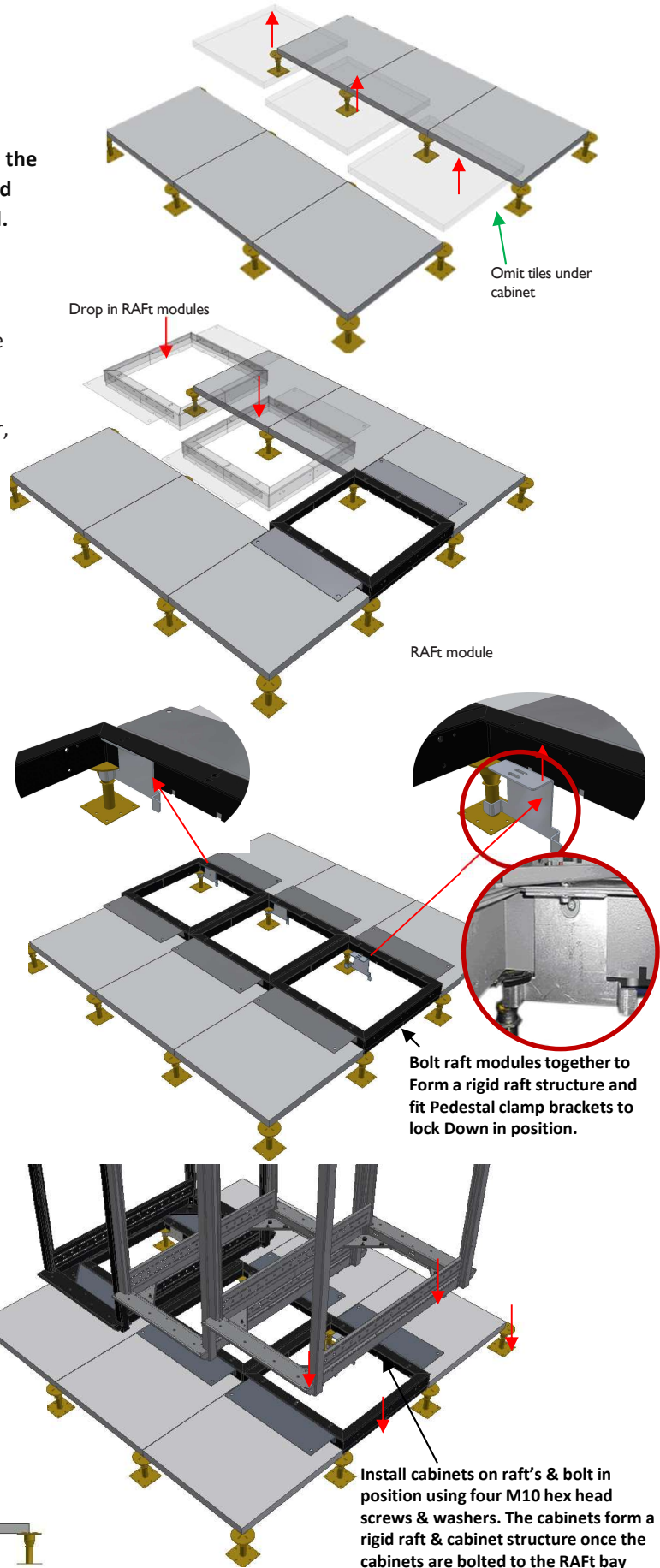
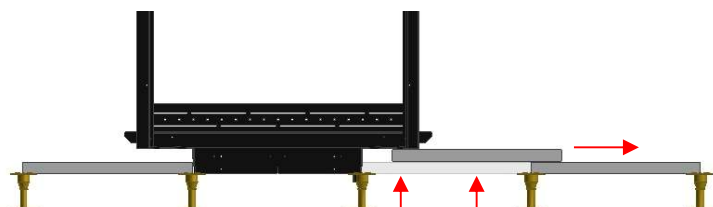

Size conversions: 1U = 44.45mm = 1 3/4" 600mm = 24" 700mm = 28" 800mm = 32" 1kg = 2.2lbs

RAft SYSTEM 600, 700 & 800 wide versions

RAft Width

It is preferable that the frame width matches the cabinet width (600, 700 or 800mm). A 700 wide or 800 wide RAft is laid out in the same manner as the 600 wide RAft except from the position of clamp brackets and the end of raft position. Where a RAft is built up from a multiple of frame widths other than the tile modular width of 600mm, it is likely that a part tile will be needed to act as a 'filler' at the end of the bay. A bracket is available (Order code: 307C00025002 cut tile support) which bolts to the end of the RAft to support this tile. However, installers should check with the flooring manufacturers as to whether extra pedestals are also required to maintain the integrity /warranty of the floor system.

RAft Brackets

RAft Stringer Clamp

Individual clamps for use with floor stringers which hook under the stringers to prevent cabinet tipping. Four clamps per cabinet recommended, one in each corner. However, if the cabinets are securely bayed together one clamp may be used at the front and the rear. The end cabinets should still have four clamps each.

RAft Pedestal Clamp

Single front and rear clamps for use when stringers are not present. These clamps are slotted for adjustment and clamp to the underside of the pedestal heads. Four clamps per cabinet recommended, one in each corner. However, if the cabinets are securely bayed together one clamp may be used at the front and the rear. The end cabinets should still have four clamps each.

RAft Pedestal Clamp - 600 Centres

Double side clamps for use when stringers are not present. These clamps are slotted for adjustment and clamp to the underside of the pedestal heads. Two clamps per cabinet recommended, one on each side. However, if the cabinets are securely bayed together one clamp may be used. The end cabinets should still have two clamps each.

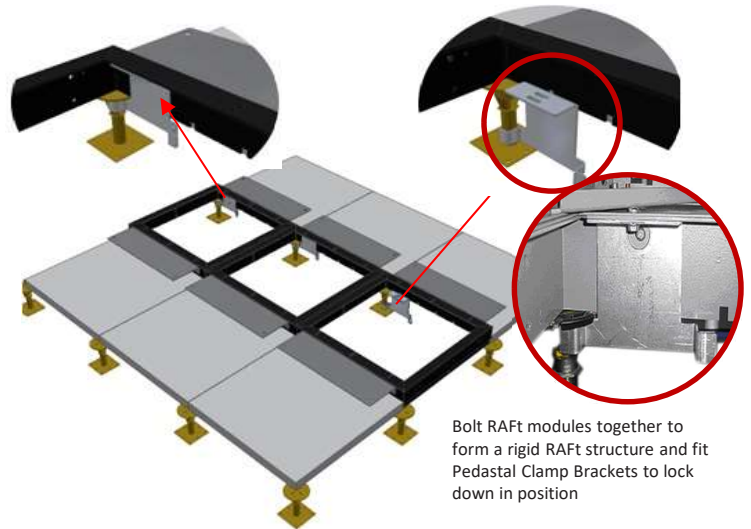

Bolt RAft modules together to form a rigid RAft structure and fit Pedestal Clamp Brackets to lock down in position

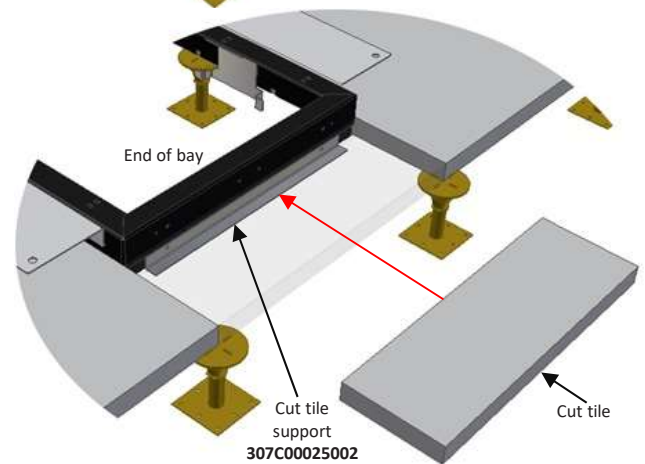

DESCRIPTION	PART CODE
RAft STRINGER CLAMP	307C01200505
RAft PEDESTAL CLAMP	307C11180500
RAft PEDESTAL CLAMP – 600 CENTRES	307C12126003
CUT TILE SUPPORT	307C00025002
RAft CLAMP ON PEDESTAL KIT	435B0067000
CLAMP ON PEDESTAL KIT	435B0067001